

# 3.00mm(.118") Wire To Wire And Wire To Board Connector



Connector & Terminal

Shenzhen Hongru Connector Co., Ltd

Email: yukyli@hrb-connector.com  
 Tel: 86-0755 2709 6669  
 Fax: 86-0755 2709 2392  
 Skype: haiyuncheng-vivian  
 Mobile(whatsapp): 86-186 8112 3590  
 Website: http://www.hrb-connector.com

## SPECIFICATIONS:

- Current Rating:5AAC,DC
- Voltage Rating:250V AC,DC
- Operating Temperature:-40°C ~+130°C
- Contact Resistance:10mΩ max.
- Insulation Resistance:1000MΩ Min.
- Withstanding Voltage:1500V AC/minute
- Material:Housing:Nylon46 UL94V-0  
Pin:Brass,Tin Plated
- Mate With:P3025Series
- Housing And Pin Retention Force Requirement: 2.0 kg (Min.)

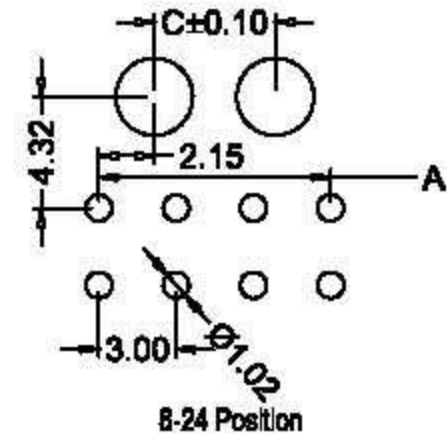
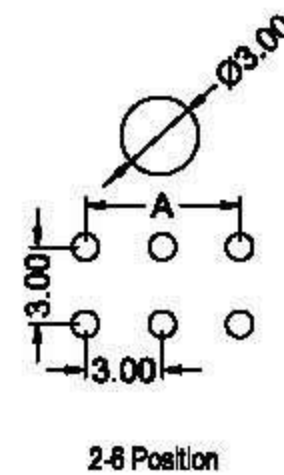
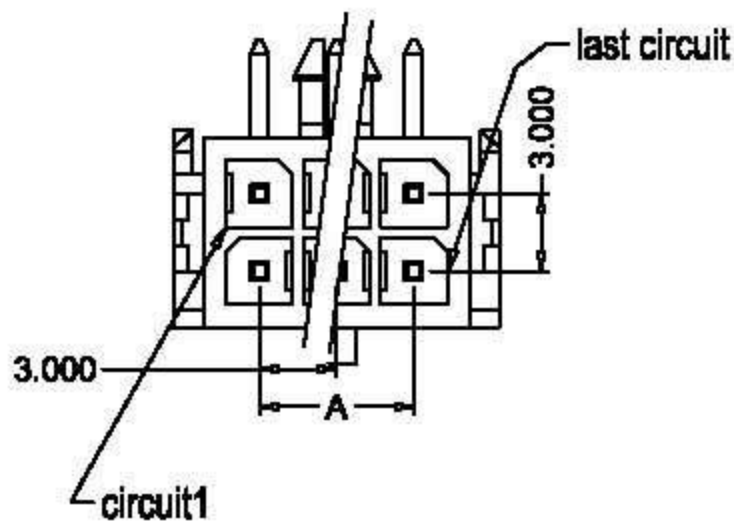
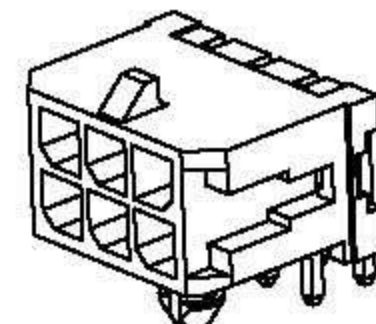

PCB LAYOUT

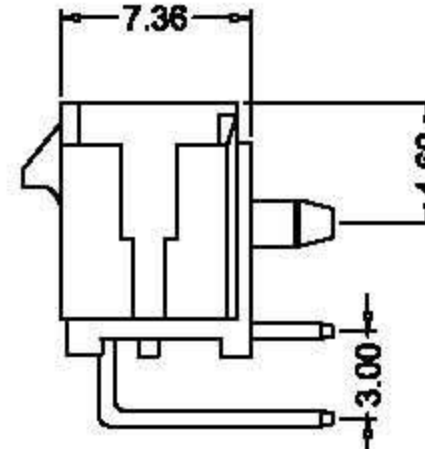
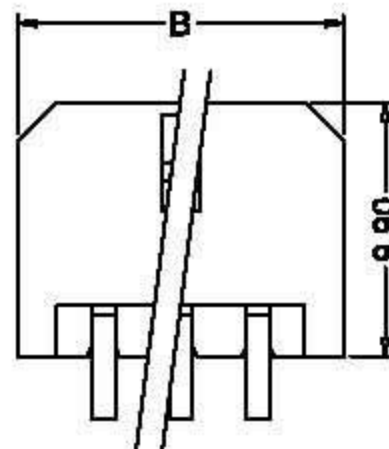

## Ordering Information And Dimensions

Part NO.		Dimensions			Part NO.		Dimensions		
TYP UL94V-0	Circuits	Dim:A	Dim:B	Dim:C	TYP UL94V-0	Circuits	Dim:A	Dim:B	Dim:C
M3045R-2x1-B-D	2	/	6.65	/	M3045R-2x7-B-D	14	18.00	24.65	13.70
M3045R-2x2-B-D	4	3.00	9.65	/	M3045R-2x8-B-D	16	21.00	27.65	16.70
M3045R-2x3-B-D	6	6.00	12.65	/	M3045R-2x9-B-D	18	24.00	30.65	19.70
M3045R-2x4-B-D	8	9.00	15.65	4.70	M3045R-2x10-B-D	20	27.00	33.65	22.70
M3045R-2x5-B-D	10	12.00	18.65	7.70	M3045R-2x11-B-D	22	30.00	36.65	25.70
M3045R-2x6-B-D	12	15.00	21.65	10.70	M3045R-2x12-B-D	24	33.00	39.65	28.70

